

## 1. Appearance

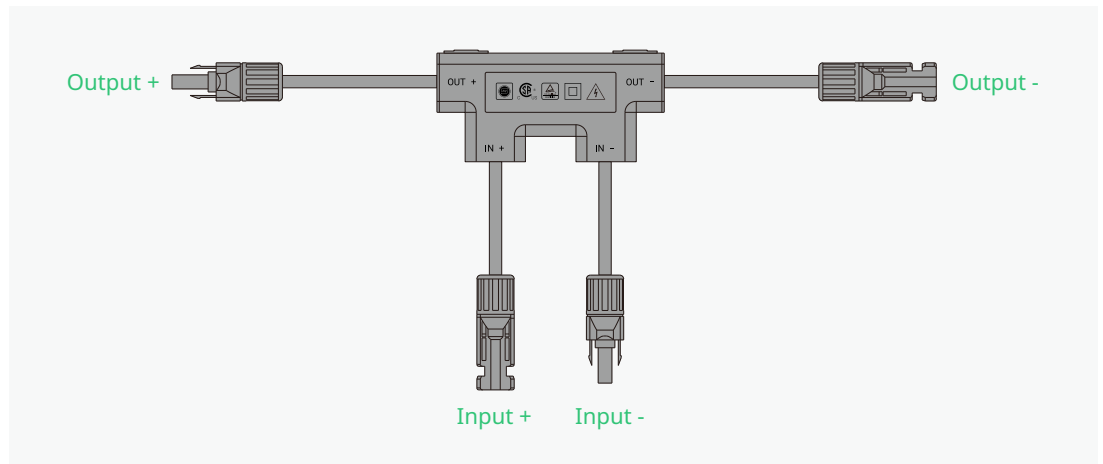

## 2. Installation

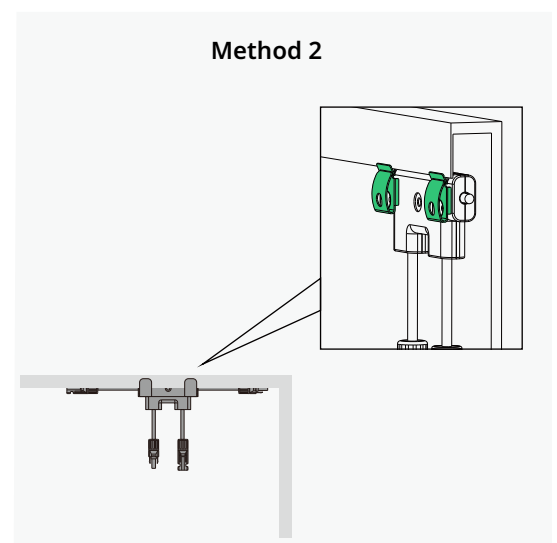
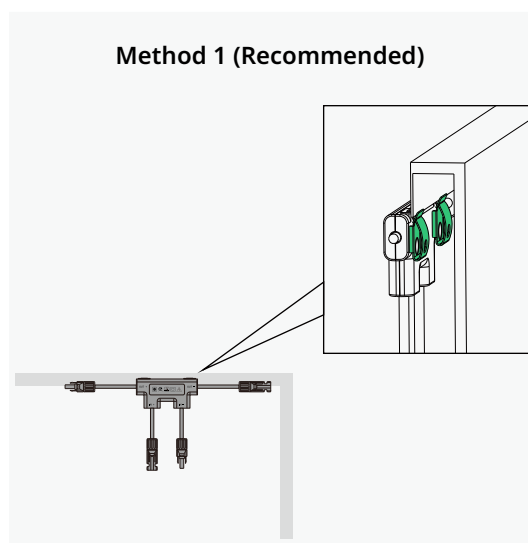
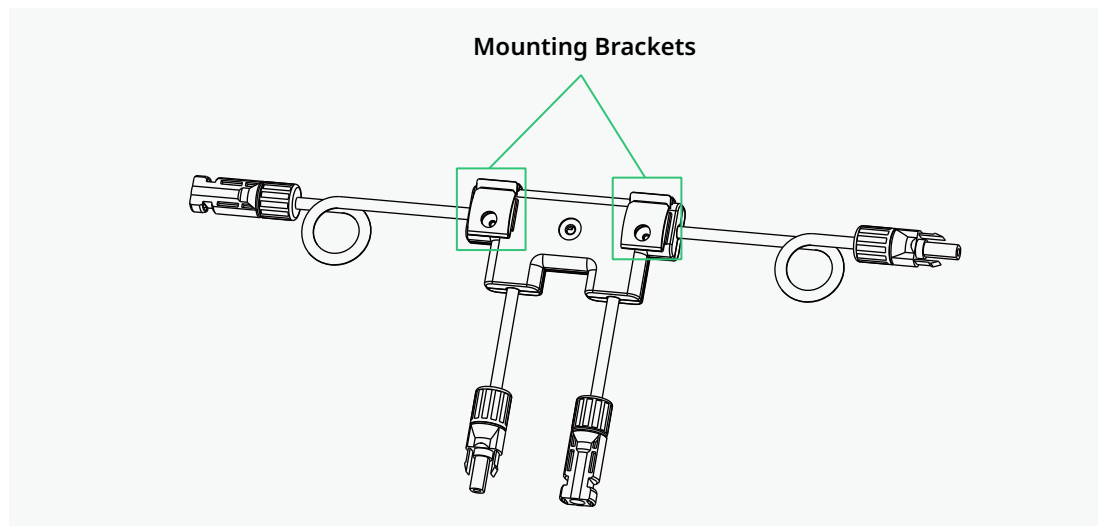

### Note:

- Allow a minimum of 1.5 cm of space between the roof and the HRSD-1C enclosure to ensure ventilation and heat dissipation.

## 3. Wiring

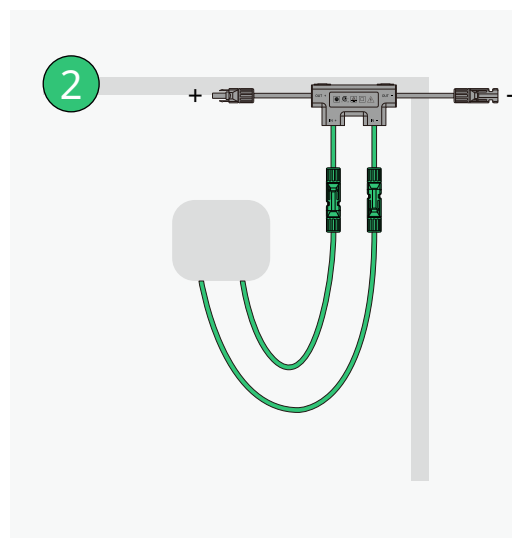
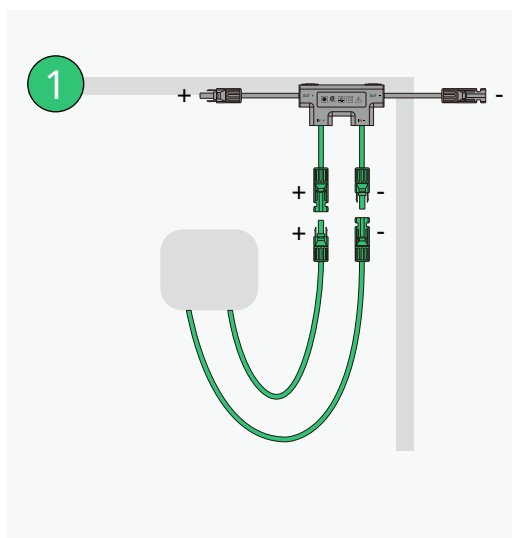

- Connect modules to HRSD inputs.

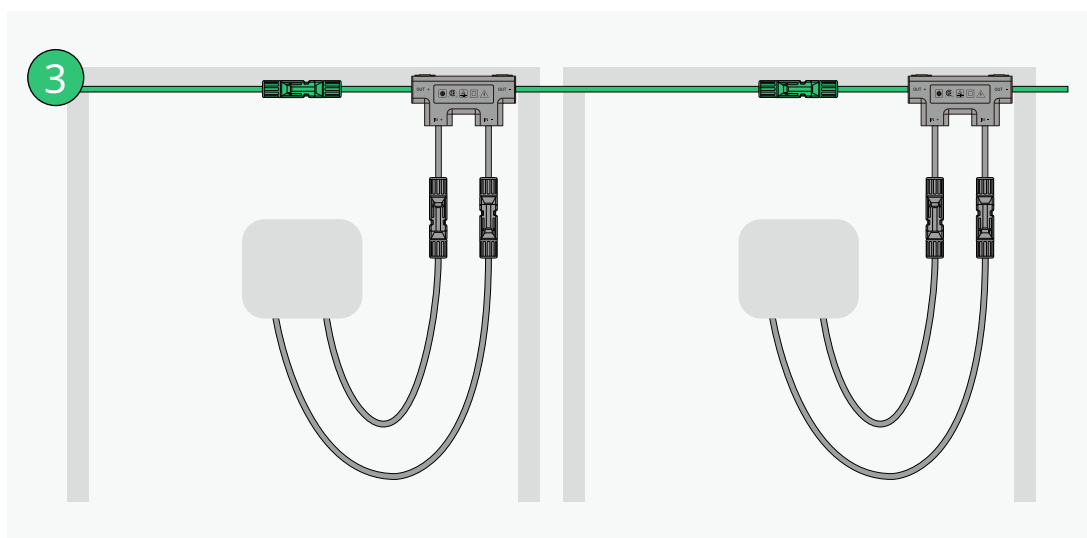

- Connect the outputs of HRSD in series.

### Note:

- When installing HRSD-1C, connect the input cables to the PV module before connecting the HRSD-1C output cables in series.
- If disconnecting HRSD-1C, disconnect the HRSD-1M output cables from the string before disconnecting the input cables from the PV module.
- Connectors from different manufacturers cannot be mated with each other.
- Transmitter must be powered off during HRSD-1C installation.
- HRSD-1C output Voltage is 0.9V to 1.1V when Transmitter "permission to operate" signal is not present.